



# HEX HEAD CAP SCREWS

BRIGHT ZINC PLATING

MANUFACTURED IN CANADA BY INFASCO

THIS DOCUMENT IS PROTECTED BY COPYRIGHT. ALL RIGHTS ARE RESERVED. NO PART OF THIS DOCUMENT MAY BE PHOTOCOPIED, REPRODUCED, OR TRANSLATED TO ANOTHER LANGUAGE WITHOUT THE WRITTEN CONSENT OF ARROW INDUSTRIAL SUPPLY, INC. THE INFORMATION CONTAINED IN THIS DOCUMENT IS SUBJECT TO CHANGE WITHOUT NOTICE. COPYRIGHT 1993.

## GRADE 5 SAE



1/4-28 DIA.		3/8-24 DIA.		1/2-20 DIA.		5/8-18 DIA.		3/4-16 DIA.		7/8-14 DIA.	
LNG	PART NUMBER	LNG	PART NUMBER	LNG	PART NUMBER	LNG	PART NUMBER	LNG	PART NUMBER	LNG	PART NUMBER
1/2	0003017540	1/2	0003018050	3/4	0003018600	1	0003019100	1	0003019410	1-1/2	0003019710
5/8	0003017550	3/4	0003018070	7/8	0003018610	1-1/4	0003019110	1-1/4	0003019420	1-3/4	0003019720
3/4	0003017560	7/8	0003018080	1	0003018620	1-1/2	0003019120	1-1/2	0003019430	2	0003019730
7/8	0003017570	1	0003018090	1-1/4	0003018640	1-3/4	0003019130	1-3/4	0003019440	2-1/4	0003019740
1	0003017580	1-1/4	0003018110	1-1/2	0003018650	2	0003019140	2	0003019450	2-1/2	0003019750
1-1/4	0003017590	1-1/2	0003018130	1-3/4	0003018660	2-1/4	0003019150	2-1/4	0003019460	2-3/4	0003019760
1-1/2	0003017610	1-3/4	0003018140	2	0003018670	2-1/2	0003019160	2-1/2	0003019470	3	0003019770
1-3/4	0003017620	2	0003018150	2-1/4	0003018680	2-3/4	0003019170	2-3/4	0003019480	3-1/4	0003019780
2	0003017630	2-1/4	0003018160	2-1/2	0003018690	3	0003019180	3	0003019490	3-1/2	0003019790
2-1/4	0003017640	2-1/2	0003018170	2-3/4	0003018700	3-1/4	0003019190	3-1/4	0003019500	3-3/4	0003019800
2-1/2	0003017650	2-3/4	0003018180	3	0003018710	3-1/2	0003019200	3-1/2	0003019510	4	0003019810
2-3/4	0003017660	3	0003018190	3-1/4	0003018720	3-3/4	0003019210	3-3/4	0003019520	4-1/2	0003019820
3	0003017670	3-1/4	0003018200	3-1/2	0003018730	4	0003019220	4	0003019530	5	0003019830
3-1/4	0003017680	3-1/2	0003018210	3-3/4	0003018740	4-1/4	0003019230	4-1/2	0003019540	5-1/2	0003019840
3-1/2	0003017690	3-3/4	0003018220	4	0003018750	4-1/2	0003019240	5	0003019550	6	0003019850
3-3/4	0003017700	4	0003018230	4-1/2	0003018760	4-3/4	0003019250	5-1/2	0003019560	7	0003019870
4	0003017710	4-1/2	0003018240	5	0003018770	5	0003019260	6	0003019570	8	0003019890
4-1/2	0003017720	5	0003018250	5-1/2	0003018780	5-1/2	0003019270	6-1/2	0003019580		
5	0003017730	5-1/2	0003018260	6	0003018790	6	0003019280	7	0003019590		
5-1/2	0003017740	6	0003018270			6-1/2	0003019290	7-1/2	0003019600		
6	0003017750					7	0003019300	8	0003019610		
						7-1/2	0003019310				
						8	0003019320				
						8-1/2	0003019330				
						9	0003019340				
						10	0003019360				

  

5/16-24 DIA.		7/16-20 DIA.		9/16-18 DIA.	
LNG	PART NUMBER	LNG	PART NUMBER	LNG	PART NUMBER
1/2	0003017800	3/4	0003018340	1	0003018800
3/4	0003017820	7/8	0003018350	1-1/4	0003018810
1	0003017840	1	0003018360	1-1/2	0003018820
1-1/4	0003017850	1-1/4	0003018380	1-3/4	0003018830
1-1/2	0003017860	1-1/2	0003018390	2	0003018840
1-3/4	0003017870	1-3/4	0003018400	2-1/4	0003018850
2	0003017880	2	0003018410	2-1/2	0003018860
2-1/4	0003017890	2-1/4	0003018420	2-3/4	0003018870
2-1/2	0003017900	2-1/2	0003018430	3	0003018880
2-3/4	0003017910	2-3/4	0003018440	3-1/4	0003018890
3	0003017920	3	0003018450	3-1/2	0003018900
3-1/4	0003017930	3-1/4	0003018460	3-3/4	0003018910
3-1/2	0003017940	3-1/2	0003018470	4	0003018920
3-3/4	0003017950	3-3/4	0003018480	4-1/2	0003018930
4	0003017960	4	0003018490	5	0003018940
4-1/2	0003017970	4-1/2	0003018500	5-1/2	0003018950
5	0003017980	5	0003018510	6	0003018960
5-1/2	0003017990	5-1/2	0003018520		
6	0003018000	6	0003018530		

1 - 14 DIA.	
LNG	PART NUMBER
1-1/2	0003019960
1-3/4	0003019970
2	0003019980
2-1/4	0003019990
2-1/2	0003020000
2-3/4	0003020010
3	0003020020
3-1/4	0003020030
3-1/2	0003020040
3-3/4	0003020050
4	0003020060
4-1/2	0003020080
5	0003020090
5-1/2	0003020100
6	0003020110
6-1/2	0003020120
7	0003020130

*We design assortments to meet  
your  
INDIVIDUAL NEEDS*

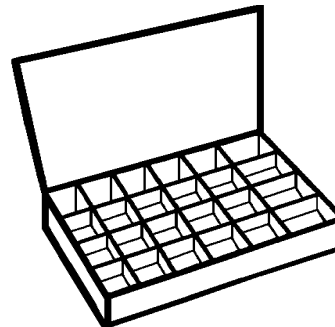

**ALL ITEMS  
AVAILABLE  
IN EASY-TO-FIND  
ASSORTMENTS**

**ASK YOUR  
SALES SPECIALIST  
ABOUT OUR  
INVENTORY MANAGEMENT  
CONTROL SYSTEM**

**1-800-225-6763**

**VISIT US ON THE WEB  
[www.arrowisi.com](http://www.arrowisi.com)**

LNG = LENGTH



# HEX HEAD CAP SCREWS

BRIGHT YELLOW ZINC PLATING

MANUFACTURED IN CANADA BY INFASCO

THIS DOCUMENT IS PROTECTED BY COPYRIGHT. ALL RIGHTS ARE RESERVED. NO PART OF THIS DOCUMENT MAY BE PHOTOCOPIED, REPRODUCED, OR TRANSLATED TO ANOTHER LANGUAGE WITHOUT THE WRITTEN CONSENT OF ARROW INDUSTRIAL SUPPLY, INC. THE INFORMATION CONTAINED IN THIS DOCUMENT IS SUBJECT TO CHANGE WITHOUT NOTICE. COPYRIGHT 1993.

## GRADE 8 SAE



1/4-28 DIA.		3/8-24 DI.		7/16-20 DIA.		9/16-18 DIA.		3/4-16 DIA.		7/8-14 DIA.	
LNG	PART NUMBER	LNG	PART NUMBER	LNG	PART NUMBER	LNG	PART NUMBER	LNG	PART NUMBER	LNG	PART NUMBER
1/2	0003040010	1/2	0003040380	3/4	0003040570	1-1/4	0003040822	1	0003040984-1	1-1/2	0003041119
5/8	0003040020	5/8	0003040390	7/8	0003040580	1-1/2	0003040824	1-1/4	0003040985	2	0003041120
3/4	0003040030	3/4	0003040400	1	0003040590	1-3/4	0003040826	1-1/2	0003040990	2-1/2	0003041140
7/8	0003040040	7/8	0003040410	1-1/4	0003040600	2	0003040828	1-3/4	0003041000	3	0003041160
1	0003040050	1	0003040420	1-1/2	0003040610	2-1/2	0003040832	2	0003041010	3-1/2	0003041170
1-1/4	0003040060	1-1/4	0003040430	1-3/4	0003040620	3	0003040836	2-1/4	0003041020	4	0003041180
1-1/2	0003040070	1-1/2	0003040440	2	0003040630	3-1/4	0003040838	2-1/2	0003041030	4-1/2	0003041190
1-3/4	0003040080	1-3/4	0003040450	2-1/4	0003040640	3-1/2	0003040840	2-3/4	0003041040	5	0003041200
2	0003040090	2	0003040460	2-1/2	0003040650	3-3/4	0003040842	3	0003041050	5-1/2	0003041210
2-1/4	0003040100	2-1/4	0003040470	2-3/4	0003040660	4	0003040844	3-1/4	0003041055	6	0003041220
2-1/2	0003040110	2-1/2	0003040480	3	0003040670	4-1/2	0003040846	3-1/2	0003041060	6-1/2	0003041221
2-3/4	0003040120	2-3/4	0003040490	3-1/4	0003040675	5	0003040848	3-3/4	0003041065	7	0003041222
3	0003040130	3	0003040500	3-1/2	0003040680			4	0003041070	7-1/2	0003041223
3-1/4	0003040135	3-1/4	0003040505	3-3/4	0003040685	<b>5/8-18 DIA.</b>		4-1/2	0003041080	8	0003041224
3-1/2	0003040140	3-1/2	0003040510	4	0003040690			5	0003041090	9	0003041225
3-3/4	0003040145	3-3/4	0003040515	4-1/2	0003040692	LNG	PART NUMBER	5-1/2	0003041100	10	0003041227
4	0003040150	4	0003040520	5	0003040694	1-1/4	0003040850	6	0003041110	<b>1 -14 DIA.</b>	
4-1/2	0003040160	4-1/2	0003040530	5-1/2	0003040695	1-1/2	0003040860	6-1/2	0003041111		
5	0003040170	5	0003040540	6	0003040696	1-3/4	0003040870	7	0003041112	2	0003041230
5-1/2	0003040180	5-1/2	0003040550			2	0003040880	7-1/2	0003041113	2-1/4	0003041240
		6	0003040560	<b>1/2-20 DIA.</b>		2-1/4	0003040890	8	0003041114	2-1/2	0003041250
				LNG	PART NUMBER	2-1/2	0003040900	9	0003041115	2-3/4	0003041260
				3/4	0003040698	2-3/4	0003040910	10	0003041117	3	0003041270
				7/8	0003040699	3	0003040920			3-1/2	0003041280
				1	0003040700	3-1/4	0003040925			4	0003041290
				1-1/4	0003040710	3-1/2	0003040930			4-1/2	0003042000
				1-1/2	0003040720	4	0003040940			5	0003042010
				1-3/4	0003040730	4-1/2	0003040950			5-1/2	0003042020
				2	0003040740	5	0003040960			6	0003042030
				2-1/4	0003040750	5-1/2	0003040970			6-1/2	0003042040
				2-1/2	0003040760	6	0003040980			7	0003042050
				2-3/4	0003040770	6-1/2	0003040980-1			7-1/2	0003042060
				3	0003040780	7	0003040981			10	0003042065
				3-1/4	0003040785	7-1/2	0003040982				
				3-1/2	0003040790	8	0003040983				
				4	0003040800	9	0003040984				
				4-1/2	0003040810						
				5	0003040820						
				5-1/2	0003040821						

LNG = LENGTH

**METRIC HEX HEAD CAP SCREWS ARE IN SECTION 18 SEE SECTION 13 FOR STAINLESS STEEL HEX HEAD CAP SCREWS**

**IMPORTANT NOTICE**  
 Beware of hybrid private label fasteners. Before you purchase, ask to see the *Society of Automotive Engineers (S.A.E.) Specifications*. If a fastener is not recognized by the S.A.E., you should not pay extra money for it. Most can be identified by the word "alloy" in the name. Although they may be stronger, these parts may not be specified by the **MANUFACTURER!**  
 Check with your insurance carrier before making any product changes. You may be held personally liable.

# HEX HEAD CAP SCREWS Section 3 Page 5

**BRIGHT YELLOW ZINC PLATING**

**MANUFACTURED IN CANADA BY INFASCO**

THIS DOCUMENT IS PROTECTED BY COPYRIGHT. ALL RIGHTS ARE RESERVED. NO PART OF THIS DOCUMENT MAY BE PHOTOCOPIED, REPRODUCED, OR TRANSLATED TO ANOTHER LANGUAGE WITHOUT THE WRITTEN CONSENT OF ARROW INDUSTRIAL SUPPLY, INC. THE INFORMATION CONTAINED IN THIS DOCUMENT IS SUBJECT TO CHANGE WITHOUT NOTICE. COPYRIGHT 1993.

## THREADED ROD



## THREADED ROD COUPLING



**USS  
3' LENGTHS**

**SAE  
3' LENGTHS**

**USS  
LONGER  
LENGTHS**

**B-7 HIGH  
TENSILE  
STRENGTH  
YELLOW ZINC PLATED**

**DIA. PART  
NUMBER**

DIA.	PART NUMBER
4-40	0003029999
6-32	0003029970
8-32	0003029980
10-24	0003029990
1/4-20	0003030000
5/16-18	0003030020
3/8-16	0003030040
7/16-14	0003030051
1/2-13	0003030060
5/8-11	0003030080
3/4-10	0003030100
7/8-9	0003030120
1-8	0003030130
1 1/4-7	0003030133

DIA.	PART NUMBER
8-36	0003030007
10-32	0003029995
1/4-28	0003030005
5/16-24	0003030025
3/8-24	0003030045
7/16-20	0003030055
1/2-20	0003030065
5/8-18	0003030085
3/4-16	0003030105
7/8-14	0003030122
1-14	0003030132

DIA. X LNG	PART NUMBER
8/32 x 6'	0003030007
1/4-20 x 6'	0003030010
5/16-18 x 6'	0003030030
3/8-16 x 6'	0003030050
3/8-16 x 12'	0003030049
7/16-14 x 6'	0003030057
1/2-13 x 6'	0003030070
1/2-13 x 12'	0003030075
5/8-11 x 6'	0003030090
5/8-11 x 10'	0003030095
3/4-10 x 6'	0003030110
7/8-9 x 6'	0003030124
1 1/4-7 x 6'	0003030140

3' LENGTHS	
DIA.	PART NUMBER
1/4-20	0003030144
5/16-18	0003030145
3/8-16	0003030146
7/16-14	0003030147
1/2-13	0003030148
5/8-11	0003030149
3/4-10	0003030150
3/4-16	0003030150-1
7/8-9	0003030151
1-8	0003030152
1 1/4-12	0003030128

10-24	0003030180
10-32	0003030182
1/4-20	0003030160
5/16-18	0003030162
3/8-16	0003030164
7/16-14	0003030165-1
7/16-20	0003030165
1/2-13	0003030166
1/2-20	0003030166-1
5/16-18	0003030169
7/8-9	0003030170
1-8	0003030171
1 1/4-7	0003030172

## 0-1 OIL HARDENED

### DRILL ROD FRACTIONAL 3' LONG

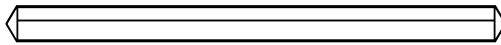

DIA.	PART NUMBER
3/16	0003030500
7/32	0003030520
1/4	0003030540
9/32	0003030560
5/16	0003030580
11/32	0003030590
3/8	0003030610
13/32	0003030630
7/16	0003030650
15/32	0003030670
1/2	0003030690
5/8	0003030730
3/4	0003030159
1	0003030161
1 1/4	0003030747
1 1/2	0003030763
3	0003030780

### METRIC 1 METER LONG

DIA.	PART NUMBER	DIA.	PART NUMBER
4mm	0003030815	15mm	0003030858
5mm	0003030820	16mm	0003030859
6mm	0003030825	17mm	0003030860
7mm	0003030830	18mm	0003030861
8mm	0003030835	19mm	0003030862
9mm	0003030840	20mm	0003030863
10mm	0003030845	21mm	0003030864
11mm	0003030850	22mm	0003030865
12mm	0003030855	23mm	0003030866
13mm	0003030856	24mm	0003030867
		25mm	0003030868

**CAN'T FIND IT?  
CALL OUR  
SPECIAL ORDER  
LINE:  
1-800-225-6763**

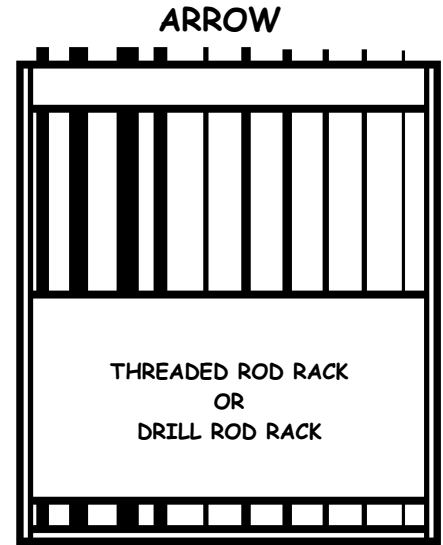

**RACKS ARE AVAILABLE THROUGH  
YOUR SALES SPECIALIST  
AND SECTION 12**

LNG = LENGTH